

FĂNĂT

1 - DURA CETATE PARCELA 12

2 - COHALMEL TARLA 20

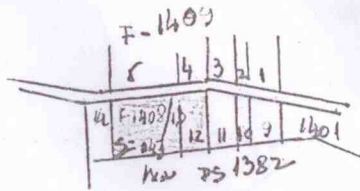

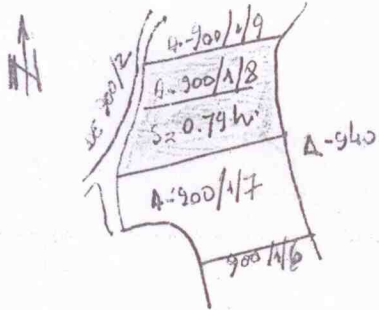

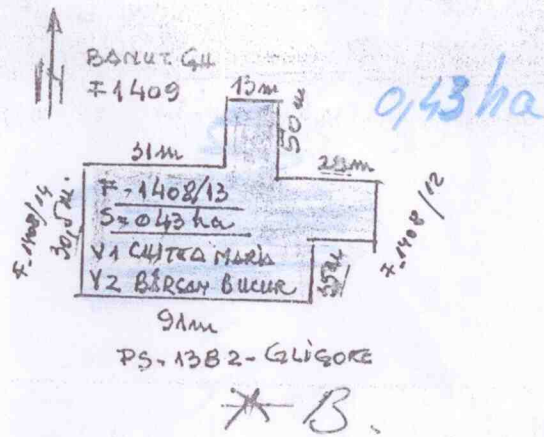
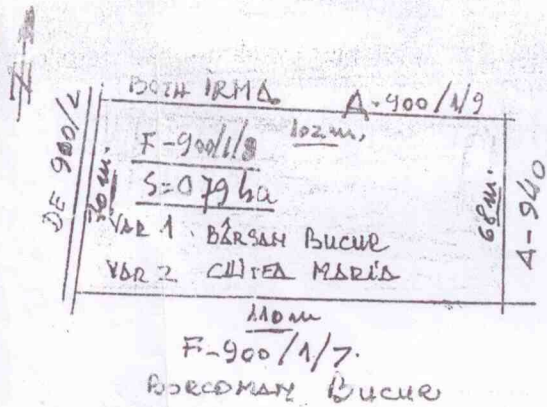

FĂNĂT

1 - DURA CETATE PARCELA 12

2 - COHALMEL



LEGENDA

-  LIMITA DE GRANITĂ ÎNTRE PARCELE
-  PARCELA PREVĂZUTĂ PENTRU CĂPTEA MARIȘ PENTRU AMBELE VĂRIȘTE
-  PARCELA PREVĂZUTĂ PENTRU BĂRSAN BUCUR PENTRU AMBELE VĂRIȘTE
-  PARCELA PREVĂZUTĂ PENTRU BĂRSAN BUCUR PENTRU AMBELE VĂRIȘTE

DUPE STRAJE PARCELA 13

4 - PE FATĂ

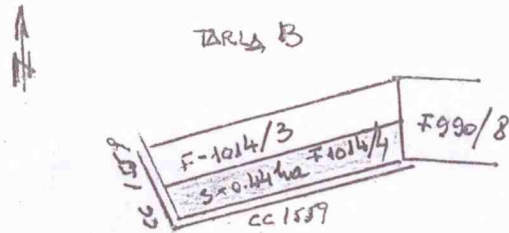
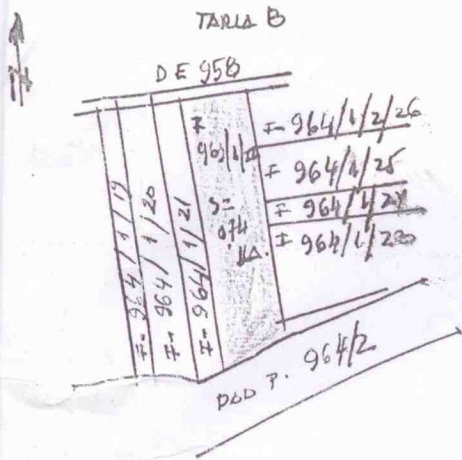

DUPE STRAJE PARCELA 13

4 - DE FATĂ

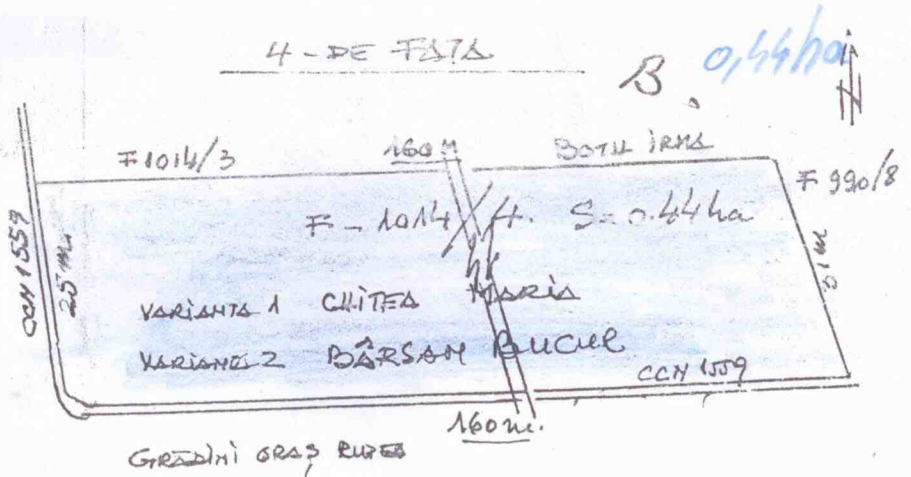
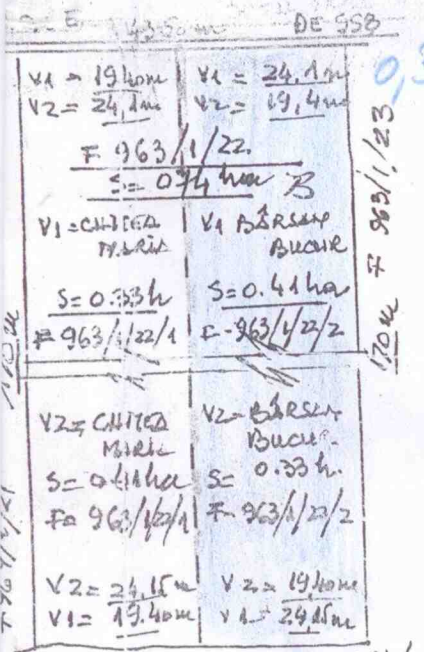

- ANEXA 8/A PLANUL Nr. 2/A

(COMPLETARE CONF. CU PREVEDERI DIN LEGEA DIN 14.12.2006
JUCATORIA - RUPEA)

NOSTAR CIVIL 197/1997, SUCCESIUNE - IESIRE
DIN INDIUZIUNE

P. RECLAMANTA : CHITEA MARIA

DOMICILIAZAT IN ORASUL RUPEA
STR. REPUBLICII NR. 179-D.

P. PARATA : BARSAN BUCUR

DOMICILIAZAT IN ORASUL RUPEA
STR. 1 DECEMBRIE 1918 NR. 102.

PLAN CU SITUATIA EXISTENTA (A) SI CEA PROPUISA PT.
ATRIBUIRE CONF. L. 18/1991 (B) DIN EVIN. OC. ADTA RUPEA
- SUCCESIUNE -

EXPERT ING. MIHAIL GHEORGHE

SAN BUCUR

CONFORM CU PLANUL DE LA O.L.A

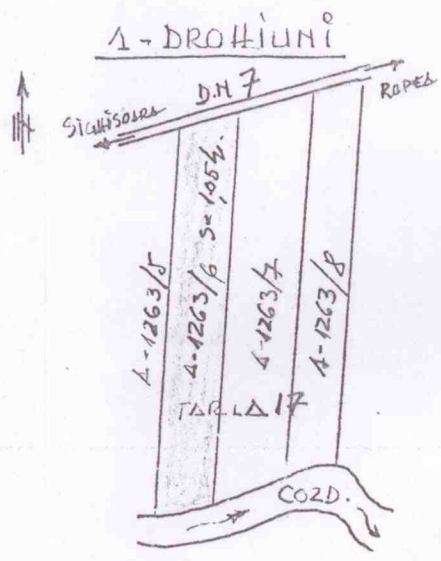

ARABIL
4/ LA MOVILA

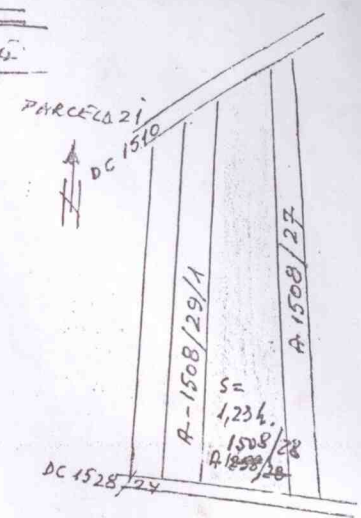

CONFORM CU PINEREA IN POSESIE

ARABIL
4/ LA MOVILA
CAT. II

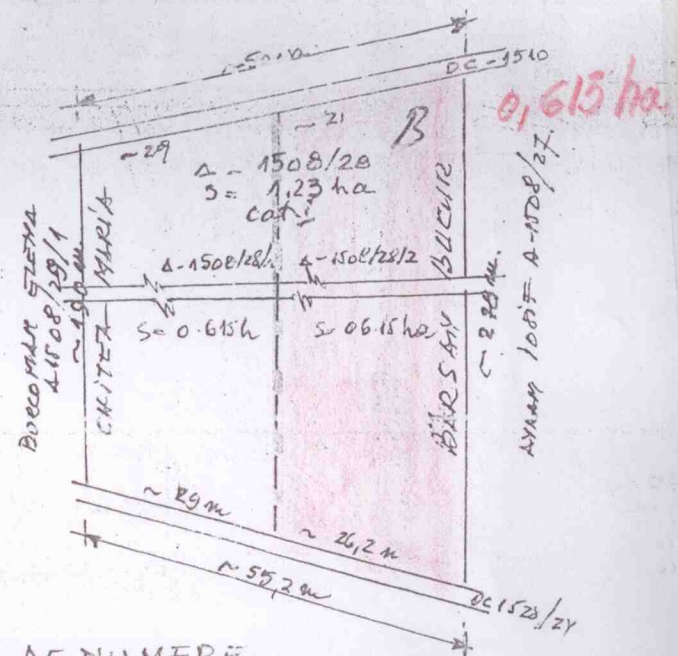
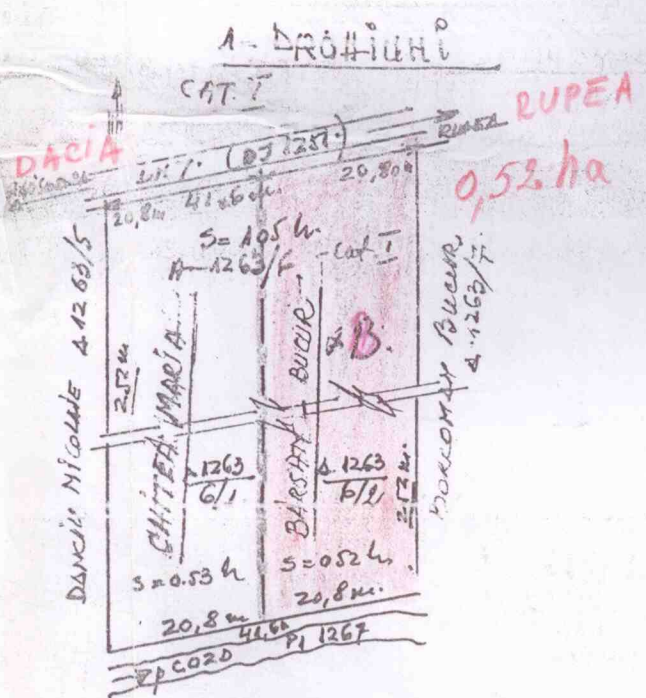

ABEL CU DEZMEMBRAREA SI ATRIBUIREA DE NUMERE
LECAD DE LA TITLUL DE PROPRIETATE NR 00303/07.04.1998 DE NUMELE BARSAN MARIA.

CONFORM TITLU DE PROPRIETATE										
DEZMEMBRAREA SI ACORDAREA DE										
VARIANTA 1.										
PARCELA NR	CATEG. FOLOSINTA	Supr. HA	CHITEA MARIA			BARSAN BUCUR			CHITEA	
			NR PARCELA	CATEG.FOL	Supr.Ha	NR PARCELA	CATEG.FOL	Supr.Ha	NR PARCELA	CATEG
1263/6	ARABIL	1.05	1263/6/1	ARABIL	0.52	1263/6/2	ARABIL	0.53	1263/6/1	ARAB
597/1/1	u-IP	0.57	597/1/1/1	u	0.285	597/1/1/2	u	0.285	597/1/1/1	u
690/3	u-III	0.99	690/3/1	u	0.495	690/3/2	u	0.495	690/3/1	u
1508/28	u-II	1.23	1508/28/1	u	0.62	1508/28/2	u	0.61	1508/28/1	u
TOTAL 1		3.84			1.92			1.92		
900/1/8	FANAT	0.79		FANAT		900/1/8	FANAT	0.79	900/1/8	FANAT
1408/13	u	0.43	1408/13	u	0.43					
963/1/22	u	0.74	963/1/22/1	u	0.33	963/1/22/2	FANAT	0.41	963/1/22/1	FANAT

TA RUPEA sc 1: 5000 (DETALIU A)

3 - PE VALEA PALOSULUI

2 - ÎN FUNDURI

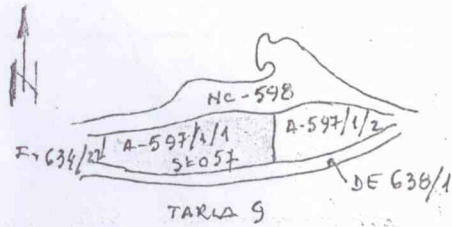
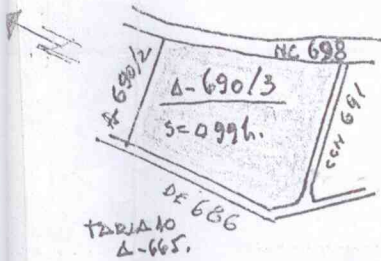

DEV. NR 4/1994 sc 1: 1000 DIN EVIDENȚA O.C.D.T.A. RUPEA (DETALIU B)

2/ÎN FUNDURI - CAT. IV

BĂRȚAN MARIA

2 - PE VALEA PALOSULUI CAT. III

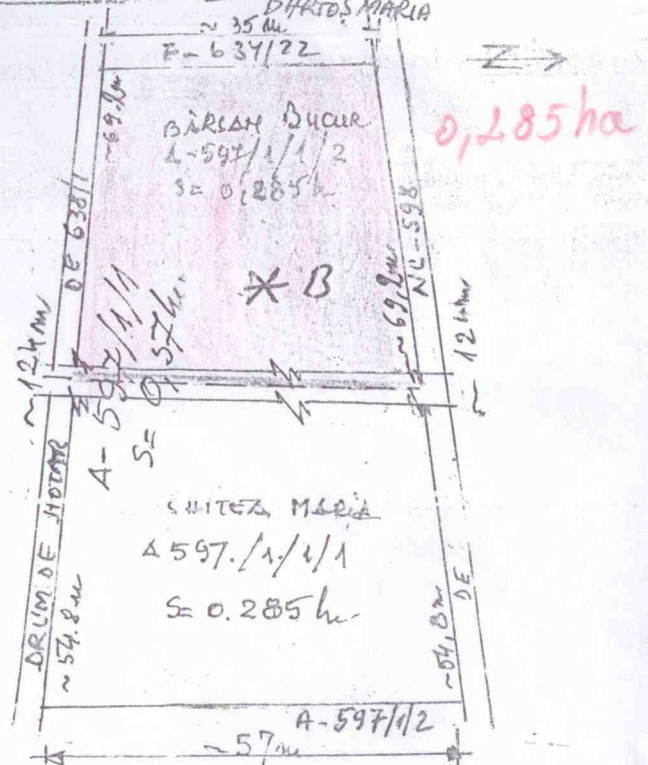
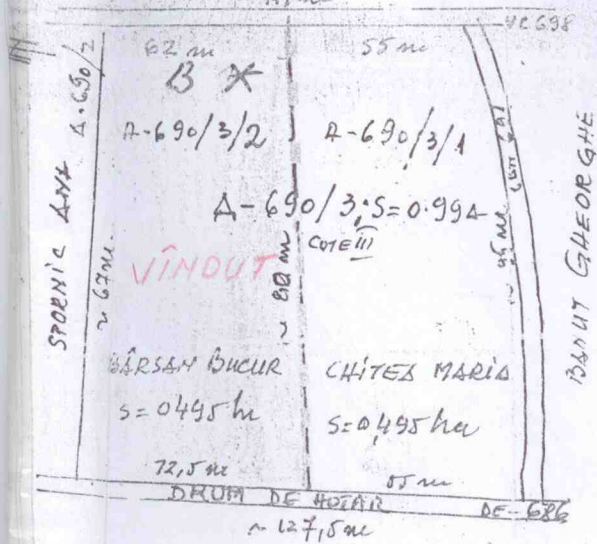

NOTĂ ÎNLEACĂND DE LA TITLUL 303/1998

1- ACORDAREA DE FORȚELE TI. CATEG. TEREH DRABIL. S-AU ACORDAT COTE 1/2 LA FIECARE PARTE ÎN AMBELE VARIANTE

2- LA CATEG. DE FORȚELE, FĂCUT S-AU ACORDAT FORȚELE LE ASTFEL CA SA SE FĂCĂTĂZE UN GRAD EGAL DE BONITATE (FERTILITATE) PENTRU A EVITA ACORDAREA EVENTUAL FLOL SULETE.

3- INTABULAREA FORȚELOR DIN LAB/1991 SI TITLU PROPRIETATEI SA FACE OBIECTUL UNEI EXPERTISE

NR. TOPO HOI				
RIANTA Z X				
MARIA		BĂRȚAN DUCUR		
FOL	SUPR. HA	NR PARCELI	CATEG. FOL	SUPR. HA
1	0.52	1263/6/2	DRABIL	0.53
2	0.285	597/1/1/2	-	0.285
3	0.495	690/3/2	-	0.495
4	0.62	1508/28/2	-	0.61
5	1.92	-	-	1.92
6	0.79	-	-	-
7	-	1408/13	FĂCUT	0.43
8	0.41	963/1/27/2	-	0.33
9	-	1044/4	-	0.44